

Project by



RERA NO. : RAJ/P/2024/2938

Presenting Exclusive Limited Edition Apartments FOR PRIVILEGED FEW



THE Grand Rudra
Premium studio apartments...

277 Khatwara, Mahindra SEZ, Behind Jayshree Periwal International School, Ajmer Road, Jaipur

Location Advantage :

UNIVERSITIES

JK Laxmipat University : 2 mints.
Bhartiya Skill Development University: 2 mints.
Dr. Radhakrishnan Engineering College : 2 mints.
Maharani Girls Engineering College : 2 mints.
JIT Collage : 2 mints.

SCHOOLS

Jayshree Periwal International School : 2 mints.
St. Xavier's College Nevta : 2 mints.
Neerja Modi School Kalwara : 5 mints.
DPS : 5 mints.
Orchid School : 5 mints.

AIRPORT

Jaipur Airport: 20 mints.

RAILWAY STATIONS

Main Railway Station : 20 mints.
Mansarovar Metro Station : 15 mints.

BUS STAND

New Sindhi Camp Bus Stand
on Ajmer Road : 10 mints.

HOSPITALS

Geetanjali Medical Hospital : 5 mints.
Shailby Hospital : 10 mints.

SHOPPING & ENTERTAINMENT

Pink Pearl Water Park : 5 mints.
Kanchan Kesari Resort : 5 mints.
Elements Mall : 20 mints.
New Aatish Market : 20 mints.

IT Hub, Manufacturing Hub, Education Hub & Commercial Hub

- Indias Largest IT SEZ
- DMIC Influence Zone
- Gems & Jewellery
- Multi Services
- (R&D, Education, Bio-technology, ITes)
- Auto Components
- Agro based products
- Free trade and warehousing
- Generation of energy through renewal sources (Solar, Wind)
- Medical Tourism
- Textile & Garments
- Stones

Location Map :



Limra Graphics



RUDRA GROUP

S-2, 1st Floor, Near Metro Pillar No. 44,
New Aatish Market, Mansarovar, Jaipur (Raj.)
info.rudragroups@gmail.com www.rudrgroup.com

Google Location



For Office



For Site

Member of:
CREDAI RAJASTHAN
Forming Together Builders & Promoters Association

Call : 9983859733

Disclaimer: Image/Facilities show above are only representational and informative, information, image and visual are only indicative of the envisaged developments and the same are subject to change in actual as per approvals. The view shown in the pictures may vary over period of time and does not guarantee the same. All intending purchase are bound to inspect all plans and approvals and visit project site and approve themselves of all plans and approvals and other relevant information obtained form time to time from respective authority. The promoter hold no responsibility for its accuracy and shall not be liable to any intending purchaser or any one for the change/alterations/improvements so made.



FULLY FURNISHED SUITES



ROOF TOP
POOL & GYM

CONVENIENCES
FOR
Quality
LIFE

THE GRAND RUDDRA

THE Grand Centre



Offering **The Best Rewards Of Life**
EXCLUSIVELY FOR YOU

Explore, discover, enjoy the various world-class amenities being offered.



COMMUNITY HALL



ISOMETRIC PLAN



Modular Kitchen

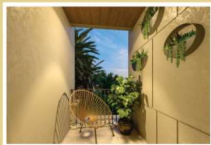

Balcony



Covered Parking



24x7 Security / CCTV

TYPICAL FLOOR PLAN

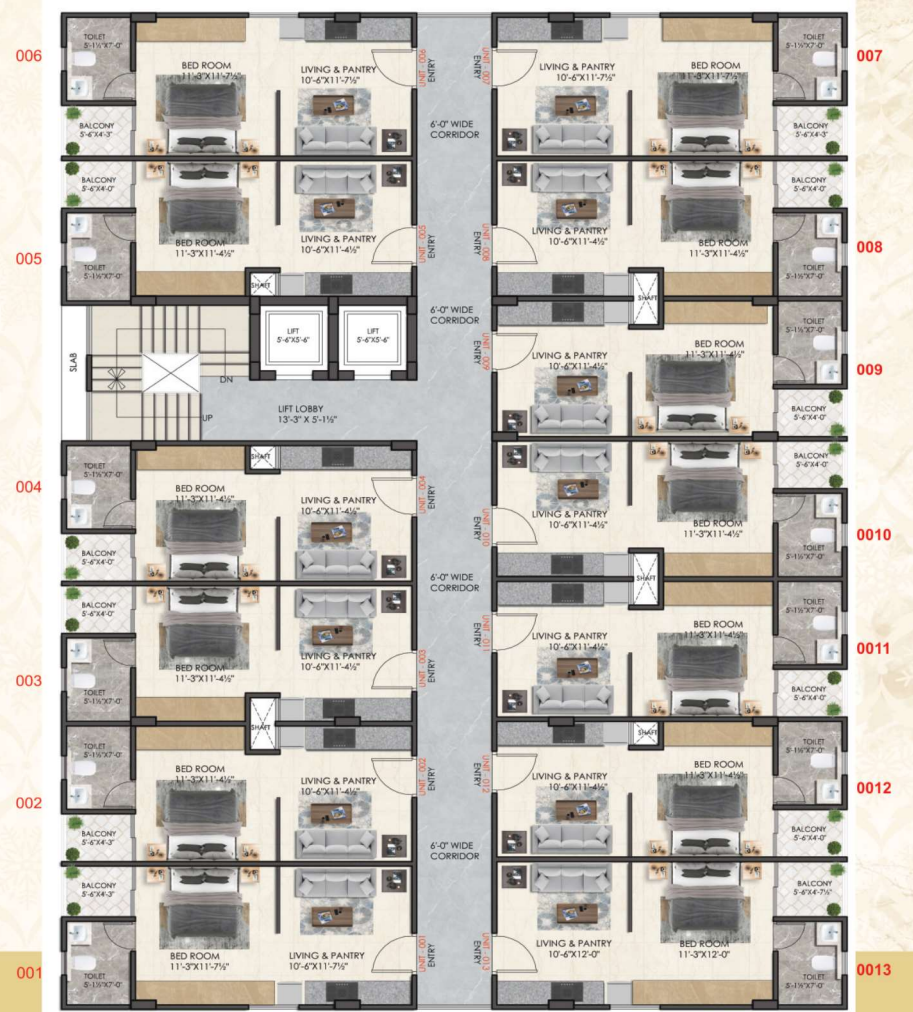

SR. NO	FLAT NO	B.U.A. (SQ.FT.)	SALEABLE AREA (SQ.FT.)	SR. NO	FLAT NO	B.U.A. (SQ.FT.)	SALEABLE AREA (SQ.FT.)
1.	Unit-001	344.29 sq.ft	482.00 sq.ft	1.	Unit-007	344.29 sq.ft	482.00 sq.ft
2.	Unit-002	331.93 sq.ft	464.70 sq.ft	2.	Unit-008	331.93 sq.ft	464.70 sq.ft
3.	Unit-003	331.93 sq.ft	464.70 sq.ft	3.	Unit-009	331.93 sq.ft	464.70 sq.ft
4.	Unit-004	331.93 sq.ft	464.70 sq.ft	4.	Unit-010	331.93 sq.ft	464.70 sq.ft
5.	Unit-005	337.23 sq.ft	472.12 sq.ft	5.	Unit-011	331.93 sq.ft	464.70 sq.ft
6.	Unit-006	344.29 sq.ft	482.00 sq.ft	6.	Unit-012	331.93 sq.ft	464.70 sq.ft
				7.	Unit-013	354.89 sq.ft	496.84 sq.ft

1 to 6 Floors Have the Same Size

Advantages



Fully Furnished Items

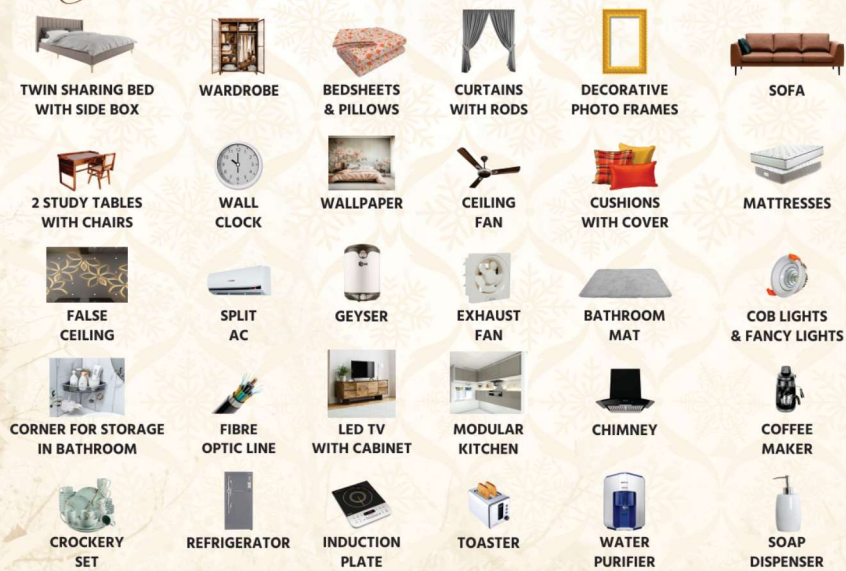

Specifications

STRUCTURE

- RCC Composite Structure with Brick Masonry and Cement plastering.

FLOORING

- Vitrified tiles flooring in Living 4x2 ft. Dining, Kitchen & Bedroom.
- Granite in Staircase.
- Stair Case Glass or Steel Railing

DOORS & WINDOWS

- All Flush Doors with Designer Laminate & Motif Locks.
- Windows & Frames in Aluminum/UPVC.
- Fittings of good quality on doors and windows.

KITCHEN

- Modular Kitchen with Chimney.
- Granite working Counter with Stainless Steel Sink.
- 2' Ft. high designer tiles dado above the counter.
- Exhaust Fan will be provided.

BATHROOMS

- Premium Class C.P. fittings.
- Premium Class Sanitary Ware in all Bathrooms.
- Tiles on walls upto Door height.
- Anti-skid Tiles on Floor.
- Under Ground Water Tank

ELECTRICALS

- Modern electrical system with concealed Wiring.
- Premium Quality Modular Switches & Accessories.
- TV/Telephone/A.C. points at appropriate places.
- AC Copper piping in Drawing room & all Bedrooms.

P.O.P & PAINT

- POP finish on Walls.
- Premium Paint on Internal walls & Ceilings.
- Exterior Facade in Texture Paint finish and Designer Tiles.
- Facade will be in Balcony with Glass Railing.



Rooftop Cafeteria



Rooftop Open Gym



Rooftop Swimming Pool



Community Hall



Visitor Room



2 Elevators

Why SEZ

Mahindra Group and RIICO (a Govt. of Rajasthan undertaking), Mahindra World City, Jaipur is at par with the best business destinations in the world.

Spread across 3,000-acres with a 2,000-acre multi-product SEZ, the Mahindra City serves as a conduit between entire North India and the ports of the Western

coast.

Jaipur has attracted companies such as Genpact, Coca Cola, Ericsson, Patro, Mahindra Spare Parts, Ginnar Soft, Pavco, Window's Planet, Gaston Energy, Poly Medicare Ltd., Rexam, MICO, JCB, Infosys and NEI with its investment friendly climate and pro-business attitude. A renowned tourism destination, Jaipur offers a cosmopolitan lifestyle coupled with superior social infrastructure.

Highlights : Promoted by the Mahindra Group and the Rajasthan State Industrial and Investment Corporation (RIICO)

Offers multi-product SEZ with dedicated zones for IT/ITeS, Engineering and Related Industries, Handicrafts, Apparel, Gems and Jewellery, Warehousing and Logistics as well as a Domestic Tariff Area (DTA) for various industries

Working Companies	More Than 130 Companies
Forecasting Companies	More Than 250 Companies
Working Employees	More Than 1,00,000 People
forecasting Employees	More Than 2,00,000 People

*Approx